

210 Josephine Ave. Milliken

SUBJECT INFO

File No.: Parcel No.:
Property Address: 210 Josephine Ave.
City: Milliken County: Weld State: Colorado ZipCode: 80543
Owner:
Client: Brett Sall Client Address: C3
Company Name: Sole Realty Services LLC Inspection Date: 09/29/2023

SKETCH

210 Josephine Ave. Milliken

1182 sf

Main Level
1181.6sf

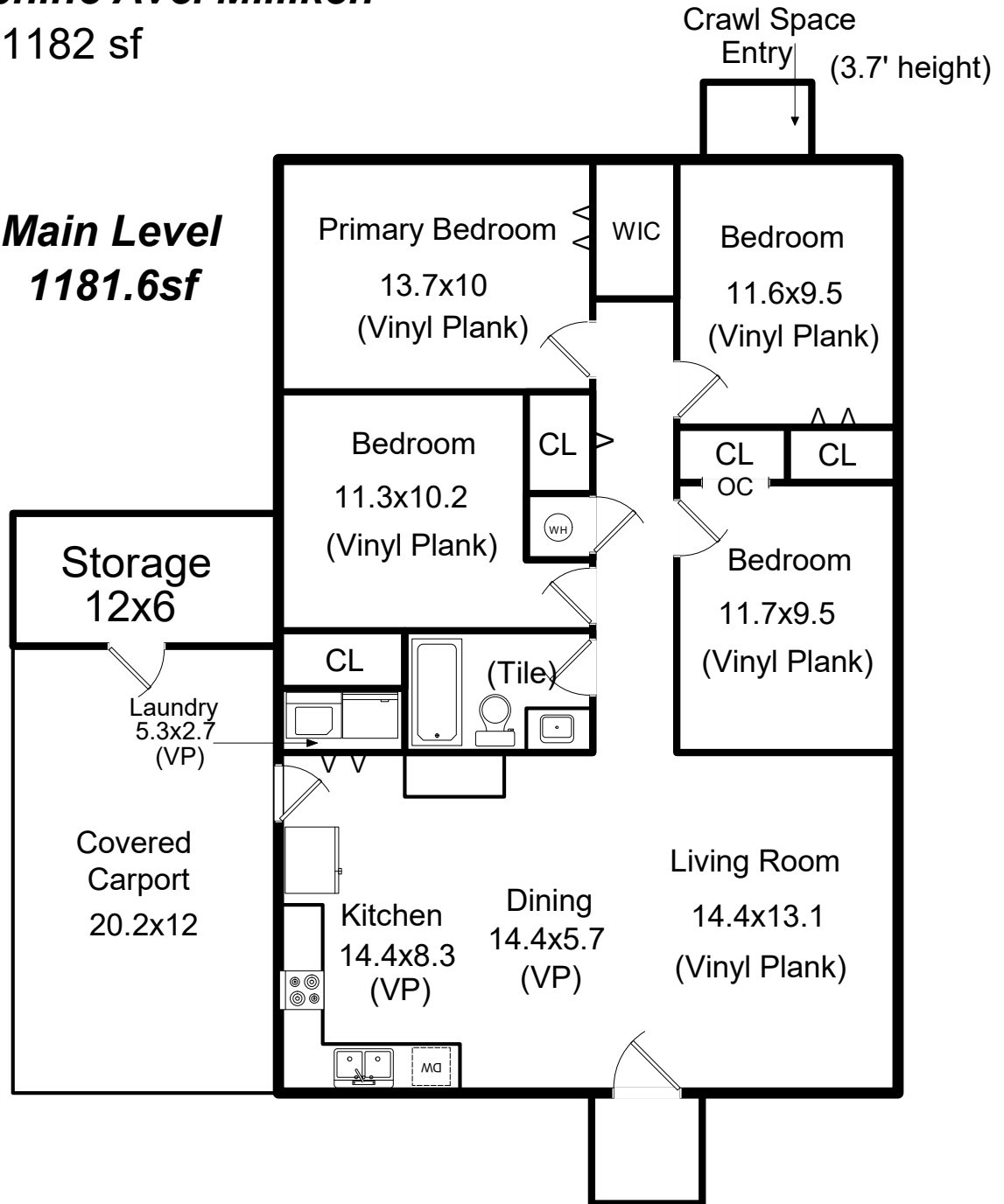

Date: 9/29/23
Copyright: Brett Sall C3
Scope of Work is on our website
Website: www.solerealtyservices.com

210 Josephine Ave. Milliken

SUBJECT INFO

File No.:	Parcel No.:		
Property Address: 210 Josepine Ave.			
City: Milliken	County: Weld	State: Colorado	ZipCode: 80543
Owner:			
Client: Brett Sall		Client Address: C3	
Company Name: Sole Realty Services LLC		Inspection Date: 09/29/2023	

SKETCH

Main Level (GBA0)

42.20 x 28.00 = 1181.60

Total area: 1181.60