

SUBJECT INFO

File No.: Parcel No.:
 Property Address: 324 river rock dr
 City: Johnstown County: State: CO ZipCode: 80534
 Owner:
 Client: agent: brett sall Client Address: info@sallteam.com
 Measured By: Sole Realty Services LLC Inspection Date: 09/06/2022

SKETCH

9/6/2022
 Sole Realty Services
 Scope of Work is on our website
 www.solerealtyservices.com
 (Copyright)

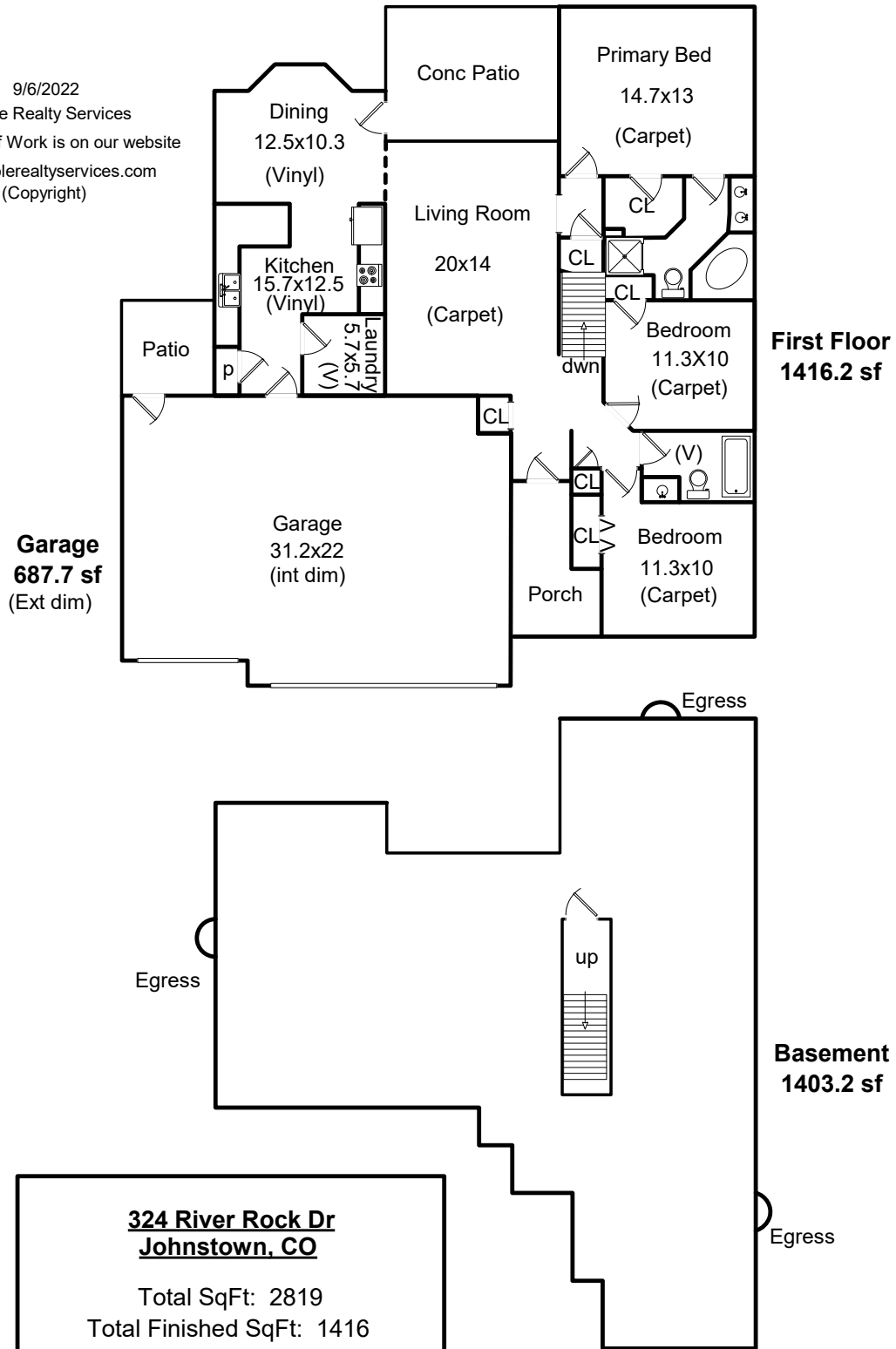

SUBJECT INFO

File No.:	Parcel No.:		
Property Address: 324 river rock dr			
City: Johnstown	County:	State: CO	ZipCode: 80534
Owner:			
Client: agent: brett sall		Client Address: info@sallteam.com	
Measured By: Sole Realty Services LLC		Inspection Date: 09/06/2022	

SKETCH**First Floor (GLA1)**

44.80	x	14.60	=	654.08
12.20	x	5.40	=	65.88
37.80	x	1.00	=	37.80
27.10	x	3.80	=	102.98
24.30	x	8.24	=	200.30
4.00	x	2.12	=	8.49
0.5	x	3.00	x	1.50 = 2.25
0.5	x	3.00	x	1.50 = 2.25
24.30	x	2.70	=	65.61
24.30	x	2.70	=	65.61
23.30	x	2.64	=	61.57
20.30	x	7.36	=	149.35
Total area:				1416.17

Garage (GLA1)

0.5	x	20.10	x	0.04 = 0.43
28.36	x	21.10	=	598.34
18.36	x	2.00	=	36.71
20.10	x	2.60	=	52.26
Total area:				687.74

Basement (GLA1)

44.80	x	14.60	=	654.08
12.20	x	5.40	=	65.88
37.80	x	1.00	=	37.80
23.30	x	6.44	=	150.11
3.80	x	3.80	=	14.44
21.00	x	20.30	=	426.30
13.64	x	4.00	=	54.57
Total area:				1403.18